

Chase me Casey



VTech understands that a child's needs and abilities change as they grow and with that in mind we develop our toys to teach and entertain at just the right level...

vtech Baby

Toys that will stimulate their interest in different textures, sounds and colours

I am...

...responding to colours, sounds and textures

...understanding cause and effect

...learning to touch, reach, grasp, sit-up, crawl and toddle

Birth-36 months



Pre-School

Interactive toys to develop their imagination and encourage language development

I want...

...to get ready for school by starting to learn the alphabet and counting

...my learning to be as fun, easy and exciting as can be

...to show my creativity with drawing and music so my whole brain develops

3-6 years



Electronic Learning Computers

Cool, aspirational and inspiring computers for curriculum related learning

I need...

...challenging activities that can keep pace with my growing mind

...intelligent technology that adapts to my level of learning

...National Curriculum based content to support what I'm learning at school

4-10 years



To learn more about this and other VTech® products, visit www.vtech.co.uk

INTRODUCTION

Thank you for purchasing **Chase me Casey** by **VTech®**.

Chase me Casey is a fun and interactive learning toy that your child will love discovering and exploring with! This adorable and cheeky little monkey skates across the floor, encouraging your little one to chase and dance with them. As your child approaches Casey, the built-in sensors detect that they are near, which makes Casey respond with sound and motion. Casey has five shape buttons that trigger fun responses and develop your child's motor skills.

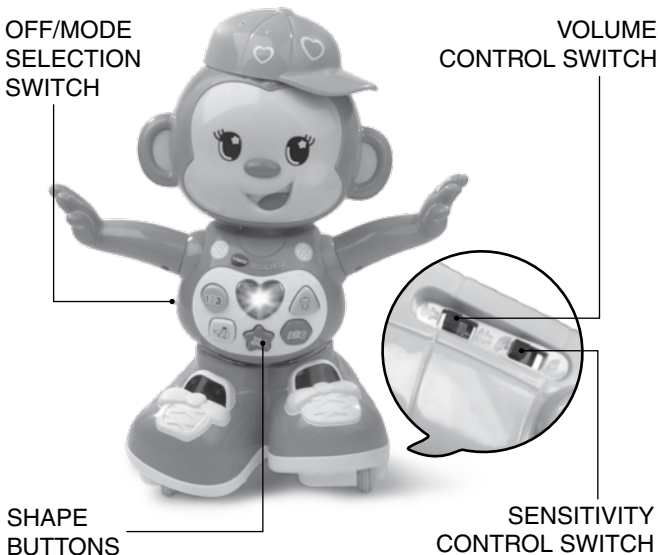

INCLUDED IN THIS PACKAGE

- One VTech® Chase me Casey
- One parent's guide

WARNING: All packing materials, such as tape, plastic sheets, wire ties and tags are not part of this toy and should be discarded for your child's safety.

NOTE: Please cut and discard the cord that attaches the block to the product. The cord is not part of this toy and should be discarded for your child's safety.

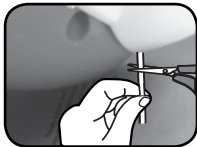

Please keep this parent's guide, as it contains important information.

Unlock the packaging locks:

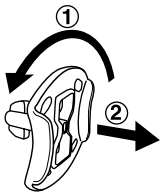

- ① Rotate the packaging lock anticlockwise 90 degrees
- ② Pull out the packaging lock.

GETTING STARTED

BATTERY INSTALLATION

1. Please make sure that **Chase me Casey** is turned **OFF**.
2. Locate the battery cover on **Chase me Casey** and use a screwdriver to loosen the screw.

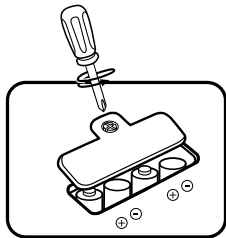

3. Install 4 new AA (LR6/AM-3) batteries following the diagram inside the battery box. (The use of new, alkaline batteries is recommended for the best performance).
4. Replace the battery cover and tighten the screw to secure.

BATTERY NOTICE

- Use new alkaline batteries or fully charged NI-MH (Nickel Metal-hydride) rechargeable batteries for best performance.
- Use only batteries of the same or equivalent type as recommended.
- Do not mix different types of batteries: alkaline, standard (carbon-zinc) or rechargeable (Ni-Cd, Ni-MH), or new and used batteries.
- Do not use damaged batteries.
- Insert batteries with the correct polarity.
- Do not short-circuit the battery terminals.
- Remove exhausted batteries from the toy.
- Remove batteries during long periods of non-use.
- Do not dispose of batteries in fire.
- Do not charge non-rechargeable batteries.
- Remove rechargeable batteries from the toy before charging (if removable).
- Rechargeable batteries are only to be charged under adult supervision.

Disposal of batteries and product



The crossed-out wheeled bin symbols on products and batteries, or on their respective packaging, indicates they must not be disposed of in domestic waste as they contain substances that can be damaging to the environment and human health.



The chemical symbols Hg, Cd or Pb, where marked, indicate that the battery contains more than the specified value of mercury (Hg), cadmium (Cd) or lead (Pb) set out in Battery Directive (2006/66/EC).

The solid bar indicates that the product was placed on the market after 13th August, 2005.

Help protect the environment by disposing of your product or batteries responsibly.

For more information, please visit:

www.recycle-more.co.uk

www.recyclenow.com

PRODUCT FEATURES

1. TO ACTIVATE NORMAL PLAY

By default, **Chase me Casey** will be in “try me” mode. To exit “try me” mode, please remove the “try me” tag from the back of the toy. Then, turn **Chase me Casey** off and on again to proceed with normal play.

2. OFF/MODE SELECTION SWITCH

To turn **Chase me Casey** ON, slide the **OFF/MODE SELECTION SWITCH** to the **Dancing Mode** (🎵🎵) or the **Catch me Mode** (☰👤) position. To turn **Chase me Casey** OFF, slide the **OFF/MODE SELECTION SWITCH** to the **OFF (OFF)** position.

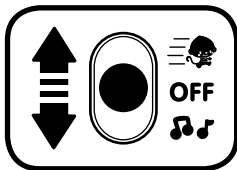

3. VOLUME CONTROL SWITCH

To adjust the volume, slide the **VOLUME CONTROL SWITCH** to the **LOW VOLUME** (🔊) or the **HIGH VOLUME** (🔊) position.

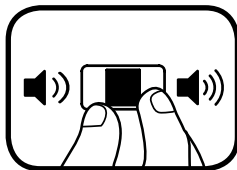

4. SHAPE BUTTONS

Press the five **SHAPE BUTTONS** to learn letters, numbers, body parts, music and to feed Casey a banana!



5. SENSITIVITY CONTROL SWITCH

Slide the **SENSITIVITY CONTROL SWITCH** to the **HIGH** (📶) or **LOW** (📶) position to adjust the sensitivity of the front and back sensor of Casey.

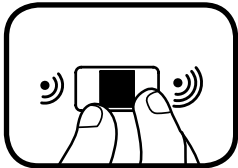

6. AUTOMATIC SHUT OFF

To preserve battery life, **Chase me Casey** will automatically shut off after approximately 50 seconds without input. Casey can be turned on again by pressing any button.

NOTE: If **Chase me Casey** repeatedly shuts off while playing, we suggest changing the batteries.

ACTIVITIES

- Slide the **OFF/MODE SELECTION SWITCH** to the **Dancing Mode** (🎵🎵) or the **Catch me Mode** (👤👤) position to turn **Chase me Casey ON**. You will hear a fun song, a phrase and a sound. Casey will dance to the music. The lights will flash with the sounds.

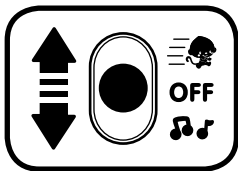

2. In **Catch Me Mode**, Casey will skate away and encourage your child to chase them. Casey can sense when obstacles are near, and will turn around and skate in the other direction to avoid collisions. Press the **SHAPE BUTTONS** to hear music, phrases and sound effects in this mode.

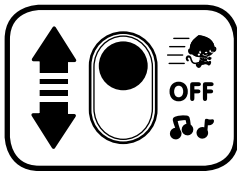

3. In **Dancing Mode**, press the **SHAPE BUTTONS** to learn letters, numbers, body parts, music and to feed Casey a banana! Casey will dance to the music, and can also sense when your child is near, encouraging them to press the **SHAPE BUTTONS** and to dance.

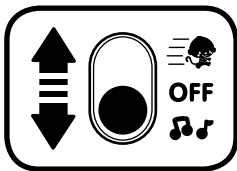

MELODY LIST

1. For He's a Jolly Good Fellow
2. Daring Young Man on the Flying Trapeze
3. The Entertainer
4. Animal Fair
5. Big Rock Candy Mountain
6. Can Can
7. Goosey Goosey Gander
8. Yellow Rose of Texas
9. Alphabet song
10. One, Two, Buckle My Shoe
11. Ta Ra Ra Boom De Ay
12. Camptown Races
13. Turkey In the Straw
14. ABC Tumble Down D
15. Blow the Man Down

SING-ALONG SONG LYRICS

SONG 1

One-two-three, can you catch me?
Doo-dah-doo-dah,
I like to skate, very quickly,
Oh-dah-doo-dah day

SONG 2

ABCDEFGH
IJKLMNOP
QRSTUW
WXYZ.

SONG 3

The wheels on my skates spin round and round,
All day long!

CARE & MAINTENANCE

1. Keep the toy clean by wiping it with a slightly damp cloth.
2. Keep **Chase me Casey** out of direct sunlight and away from any direct heat source.
3. Remove the batteries when **Chase me Casey** will not be in use for an extended period of time.
4. Do not drop **Chase me Casey** on hard surfaces and do not expose the toy to moisture or water.
5. For best performance, it is recommended that you use new batteries, otherwise **Chase me Casey** may move slowly. Do not mix old and new batteries, different types of batteries, etc.
6. It is not recommended to play with this toy in bright sunlight, as bright light will affect the sensors. It is also not recommended to play with this toy outside.
7. It is recommended to play with this toy in open spaces, free of obstacles that **Chase me Casey** might bump into.

8. For the best possible performance, it is not recommended to play with this toy on thick carpet or rugs. Solid, smooth surfaces are the best.
9. If you receive an abnormal response or no response at all from the toy, please turn **Chase me Casey OFF**, replace the batteries and then turn the toy **ON** again.
10. It is recommended to clean the floor before playing with **Chase me Casey**, as any dirt might drag into the wheels, potentially causing damage to the toy.
11. If **Chase me Casey** starts moving slowly, this is a sign the batteries are low on power, it is then recommended to replace the existing batteries with a brand new set.

TROUBLESHOOTING

If for some reason the program/activity stops working or malfunctions, please follow these steps:

1. Please turn the toy **OFF**.
2. Interrupt the power supply by removing the batteries.
3. Let the toy sit for a few minutes, then replace the batteries.
4. Turn the toy **ON**. **Chase me Casey** should now be ready to play with again.
5. If **Chase me Casey** still does not work, replace the batteries with a brand new set.

If the problem persists, please call our Consumer Services Department on 03306780149 (from UK) or + 44 3306780149 (outside UK) and a service representative will be happy to help you.

IMPORTANT NOTE:

Creating and developing **VTech®** products is accompanied by a responsibility that we take very seriously. We make every effort to ensure the accuracy of the information, which forms the value of our products. However, errors sometimes can occur. It is important for you to know that we stand behind our products and encourage you to call our Consumer Services Department on 03306780149 (from UK) or + 44 3306780149 (outside UK), with any problems and/or suggestions that you might have. A service representative will be happy to help you.



CLASS 1
LED PRODUCT



PRODUCT REGISTRATION

Visit www.vtech.co.uk/clubvtech/login
to register your VTech product

By joining the VTech Club you can also enter competitions, find out about news and events, seek expert advice for parents and let your kids play fun learning games and activities.



PRODUCT WARRANTY

Thank you for choosing this quality product from VTech. We hope it will bring many hours of entertainment, imaginative play and learning.

1. The product detailed above is covered by a one year warranty from the date of purchase, against any defects in materials or workmanship.
2. The product may be returned to the place of purchase. Alternatively the product can be returned to VTech Electronics Europe plc (see address below), with proof of purchase, without proof of purchase no replacement will be provided.
3. VTech Electronics Europe plc will examine the product and if it is found to be defective due to faulty materials or workmanship, will replace the product at their discretion.
4. If the product covered by this warranty is damaged due to misuse, modification or unauthorised repair, or because of faulty batteries, battery discharge or incorrect electrical connections, then this warranty becomes void.
5. This warranty is personal to the original purchaser and is not transferable.
6. Breakages to the LCD screen are not covered by the warranty.
7. Returns to VTech Electronics Europe plc should include a cheque or postal order for £1.50 towards the cost of return postage and packaging.
8. Products returned to VTech Electronics Europe plc, should be addressed as follows and packed carefully to avoid damage in transit (Please do not include batteries or adaptor). Please include details of the fault together with your name and address.
9. To keep an online record of your warranty, please register your product online at www.vtech.co.uk/warranty

Vtech Electronics EU PLC, c/o XPO Logistics, Warehouse 350, Cat & Fiddle Lane, West Hallam, DE7 6HE

THIS WARRANTY IS OFFERED AS AN EXTRA BENEFIT AND DOES NOT AFFECT CONSUMERS' STATUTORY RIGHTS.

This warranty is valid for the UK and Eire only. For products purchased outside the UK and Eire, please contact your local distributor or place of purchase.



**Visit our website for more
information about our products,
downloads, resources and more.**

www.vtech.co.uk

